



CHARLESTON

DESIGN DISTRICT

**NAVY YARD**

---

CHARLESTON

# CHARLESTON

DESIGN DISTRICT

## An Outpost of Style & Beauty

Navy Yard Charleston has established the Charleston Design District with showrooms for exclusive home furnishing lines, a place for designers to gather, work, source, and meet over coffee for inspiration. We have deep experience creating some of the most unique design and maker districts and a genuine commitment to a culture of supporting and fostering local design, maker, and retail businesses across the country, including Boston Design Center, Ponce City Market, Industry City, and Westside Provisions District.



# Meet the Design District Tenants



HOLLAND & SHERRY



SCHUMACHER



THE URBAN ELECTRIC CO.



ROBERT THOMAS IRON DESIGN



PHILLIP JEFFRIES



FLORAL STUDIES



FRITZ PORTER



TEXTURES



ZUMA IMPORTS



KRAVET



SMITHEY IRONWARE



CELADON WAREHOUSE

# A Community-Forward Design-Focused Neighborhood is Taking Shape

WITH STOREHOUSE 8 & 9 AT THE CENTER OF THE DESIGN DISTRICT

CHARLESTON  
DESIGN DISTRICT

NAVY YARD  
CHARLESTON

NAVY YARD  
INDUSTRIAL CAMPUS

- STOREHOUSE 8**
- △ Holland & Sherry
  - Schumacher
  - The Shade Store
  - Stark
  - Patterson Flynn
  - Kravet
  - ☆ Hue & Dot by Mirth Studio
  - ☆ Phillip Jefferies
  - ☆ Travis & Co.

- STOREHOUSE 9**
- Textures
  - Middleton Made Knives
  - △ Artis Construction
  - △ LMC Studio
  - △ Kate McDonald Bridal
  - △ Floral Studies
  - △ Nidium Gallery
  - ☆ Zuma Imports
  - ☆ Riva Mare by Indigo Road Hospitality

- Open To The Public
- Trade Only
- △ Appointment Required
- ☆ Coming Soon



The Charleston Design District has emerged in a creative enclave of repurposed turn-of-the-century storehouses

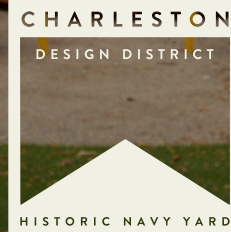

West view of plaza between Storehouse 9 (Left) and Storehouse 8 (Right)

# Mercantile & Design District

Ground Floor Retail Showroom with stairs to Mezzanine

Second Floor Boutique Showrooms



# Noisette Blvd: The Heart of the Design District



NOISETTE BLVD.

Kravet  
 Holland & Sherry  
*Hue & Dot by Mirth Studio\**  
 Patterson Flynn  
*Phillip Jefferies\**  
 Schumacher  
 Stark Carpet  
 The Shade Store  
 Travis & Co.\*

Artis Construction  
 Floral Studies  
*Riva Mare Rooftop Restaurant\**  
 Kate McDonald Bridal  
 LMC Studio  
 Middleton Made Knives  
 Nidium Gallery  
 Textures  
 Zuma Imports\*

*\*Coming Soon*

Second  
State  
Coffee

Second State Coffee brings life to our glass box cafe  
in the Storehouse Row Courtyard

876 SF CONDITIONED + COVERED TERRACE

# Rooftop Restaurant

A new full-service rooftop restaurant from acclaimed Charleston restaurateur Steve Palmer of Indigo Road Hospitality Group. The 8,200 square foot restaurant will provide indoor and outdoor seating with views of the Cooper River and historic shipyard. Opening Summer 2026.



*Riva  
Mare*

Storehouse 9 Rooftop Restaurant  
Conceptual Rendering

# Storehouse Nine

## GROUND FLOOR

LEASED

AVAILABLE

- Artis Construction
- Floral Studies
- Dwell Somatic Studio
- Kate McDonald Bridal
- LMC Studio
- Middleton Made Knives
- Nidium Gallery
- Textures
- Zuma Imports\**
- Riva Mare Rooftop Restaurant\**

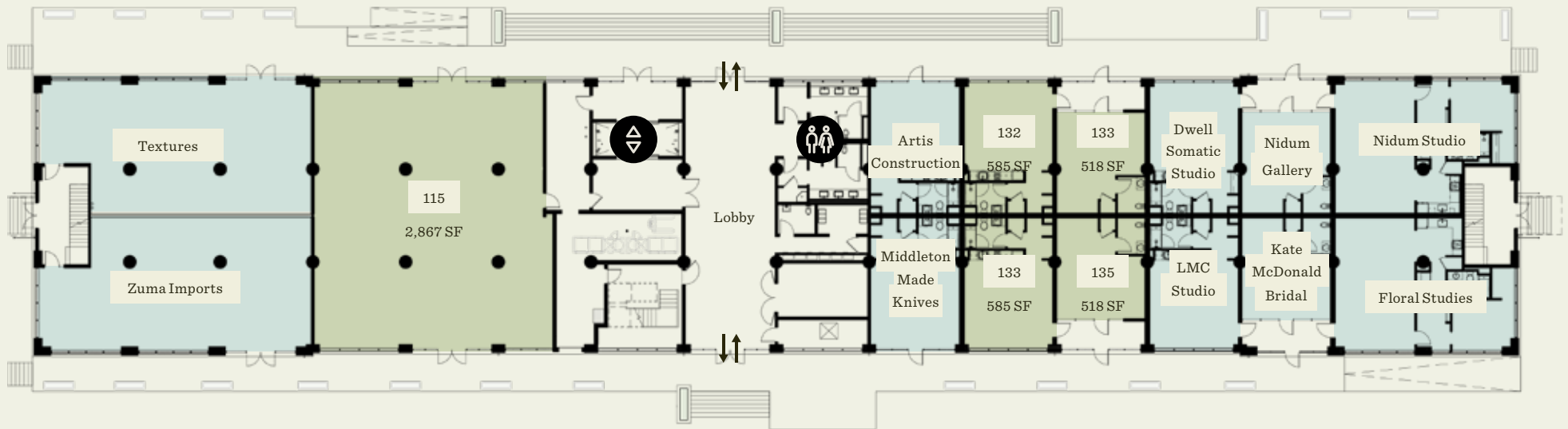

*\*Coming Soon*



LEASED  
AVAILABLE

GROUND FLOOR



MEZZANINE



Kravit  
Holland & Sherry  
Patterson Flynn  
Phillip Jeffries\*  
Schumacher  
Stark Carpet  
The Shade Store  
Travis & Co.\*

\*Coming Soon

SECOND FLOOR

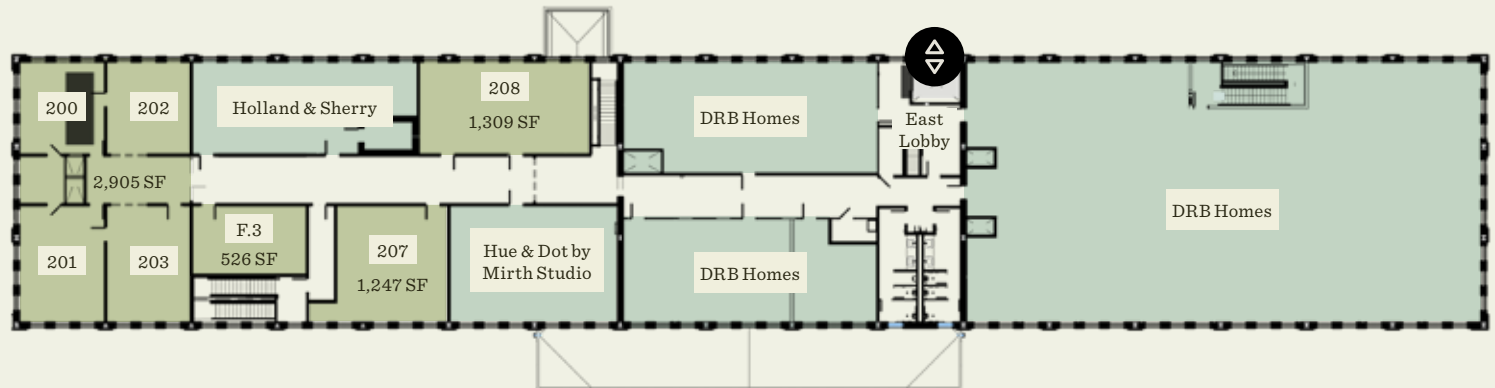

# Three Sisters Warehouses Along Noisette Boulevard



THREE SISTERS WAREHOUSES

Light-filled soaring truss ceilings and clean industrial open space serve as the backdrop in the Three Sisters Warehouses to showcase furnishings, lighting, textiles and other design elements



# Three Sisters Warehouses

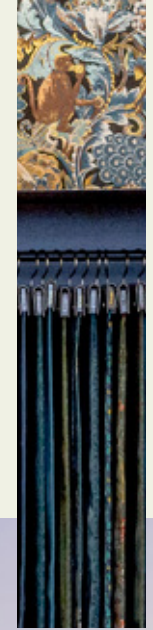
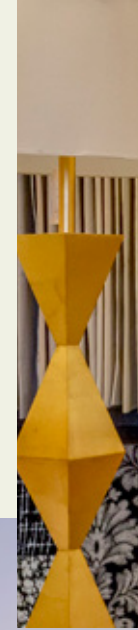

Conceptual Rendering



Flexible floorplans provide the option to increase space with additional mezzanines



Conceptual Rendering

CHARLESTON  
DESIGN DISTRICT  
HISTORIC NAVY YARD

Soaring ceilings and abundant light

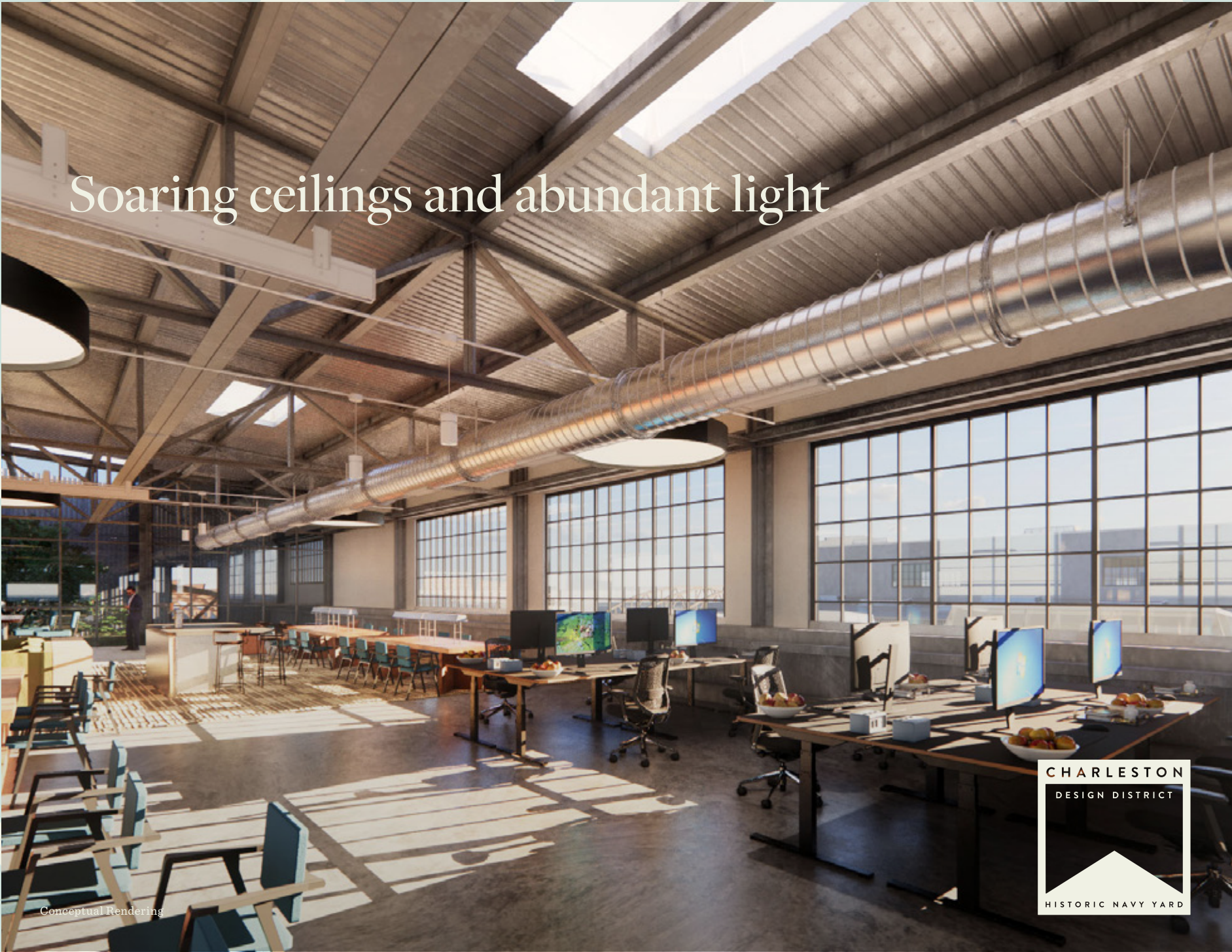

Conceptual Rendering

CHARLESTON  
DESIGN DISTRICT  
HISTORIC NAVY YARD

# Three Sisters Warehouses

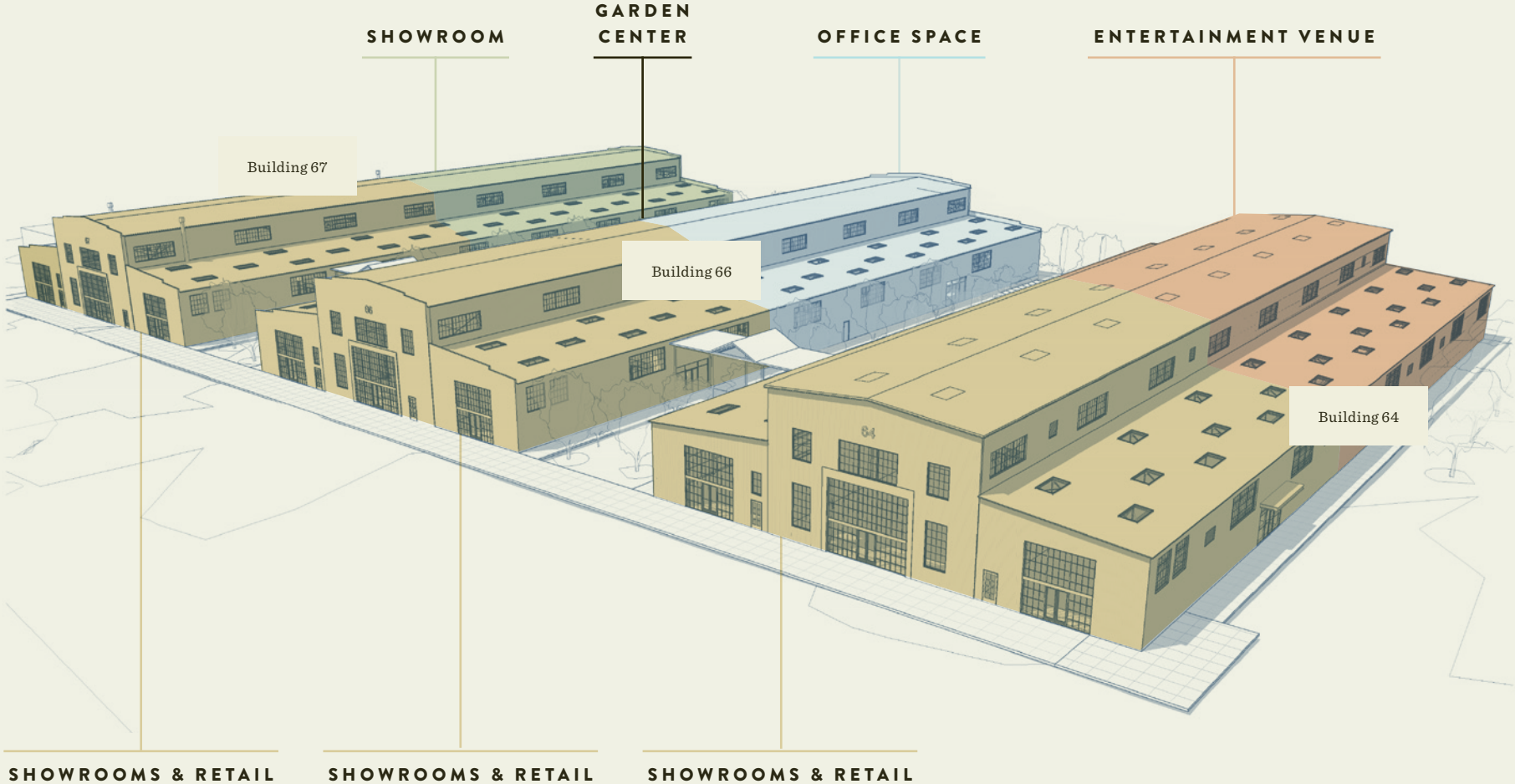

# Three Sisters Warehouses

**BUILDING 64**

<b>RETAIL</b>	<b>OFFICE</b>
<b>EVENT SPACE</b>	<b>WAREHOUSE</b>
<b>MAKER SPACE</b>	

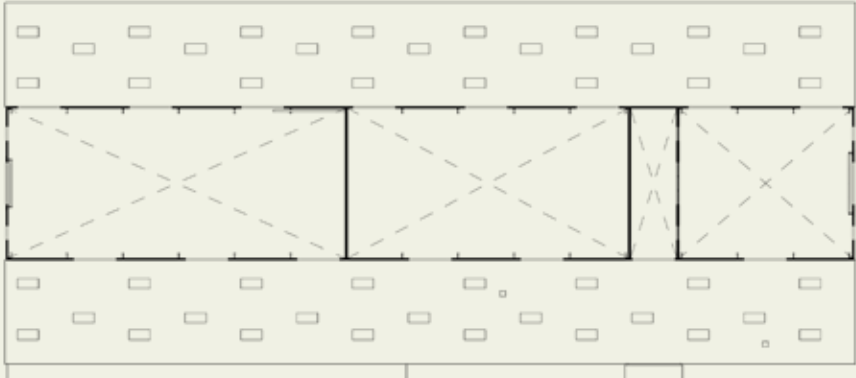

**TURNBULL AVE**

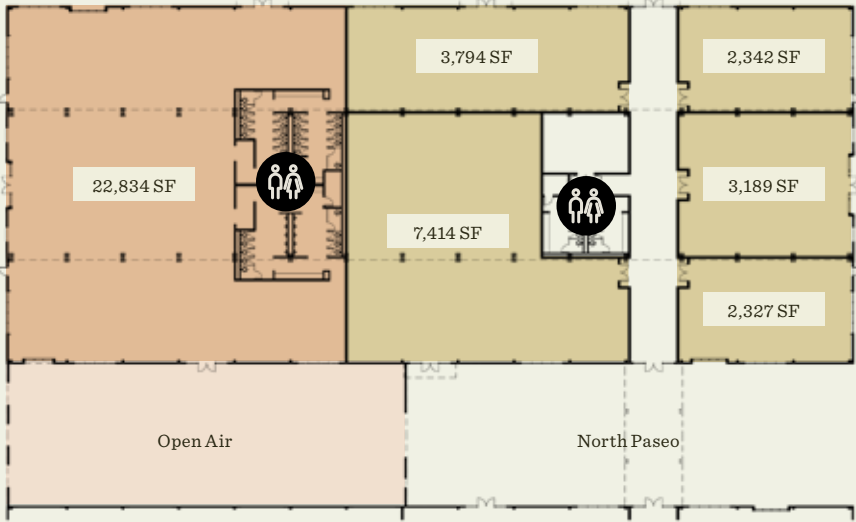
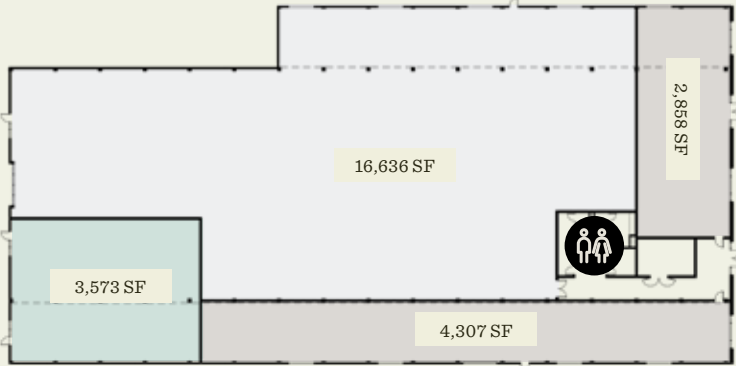

**NOISETTE BLVD**



# Three Sisters Warehouses

**BUILDING 66**

<b>RETAIL</b>	<b>OFFICE</b>
<b>GARDEN CENTER</b>	<b>WAREHOUSE</b>
<b>MAKER SPACE</b>	

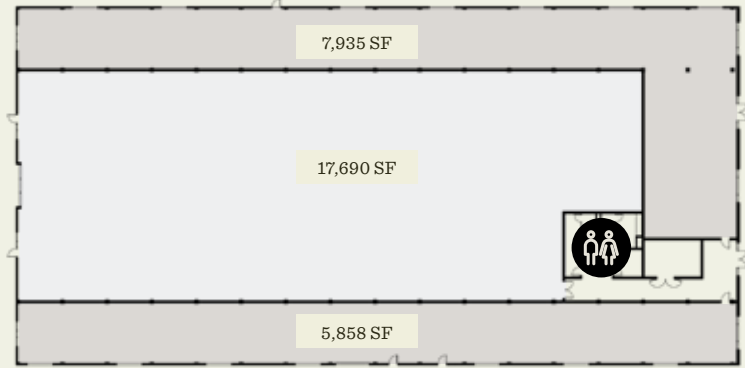

NOISETTE BLVD



# Three Sisters Warehouses

**BUILDING 67**

<b>RETAIL</b>	<b>OFFICE</b>
<b>SHOWROOM</b>	<b>WAREHOUSE</b>
<b>MAKER SPACE</b>	

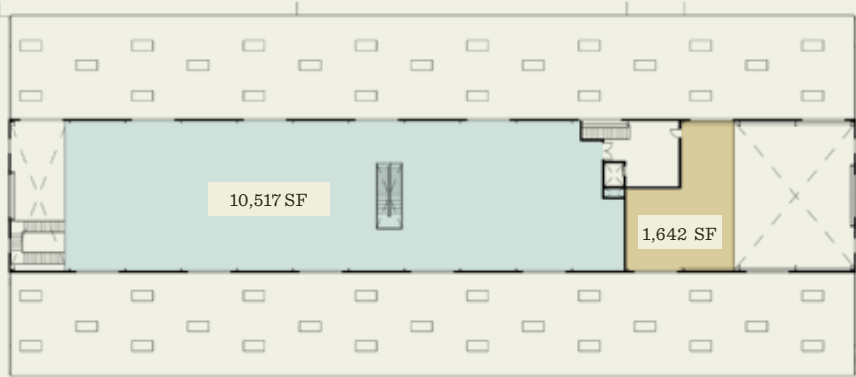

Open Air  
Garden Center  
5,114 SF

South Paseo

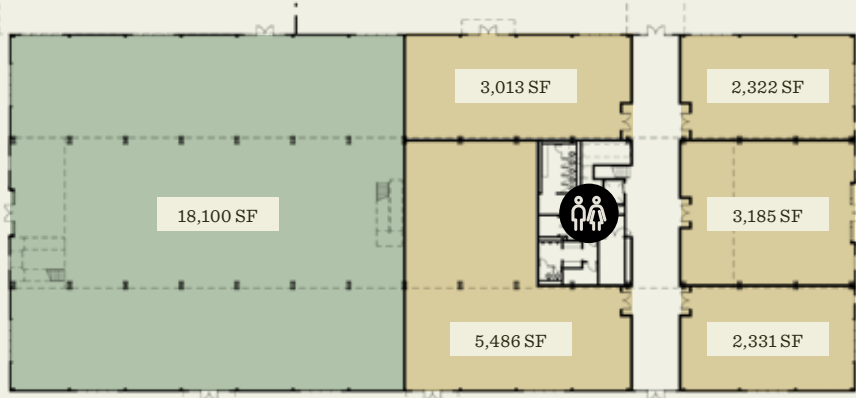
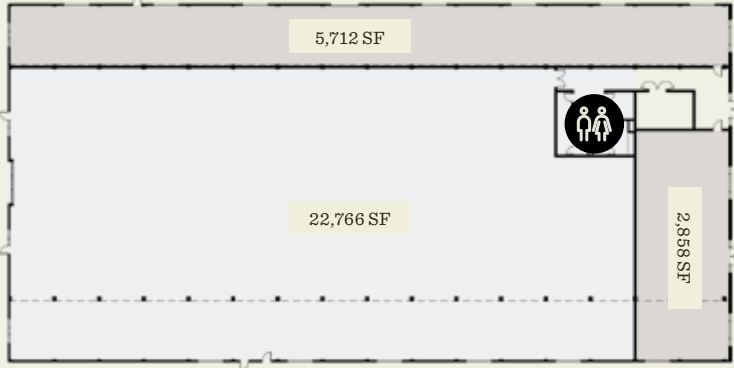

NOISETTE BLVD





# NAVY YARD

CHARLESTON

Building Momentum,  
Energizing Community

# South Carolina's Best Kept Secret



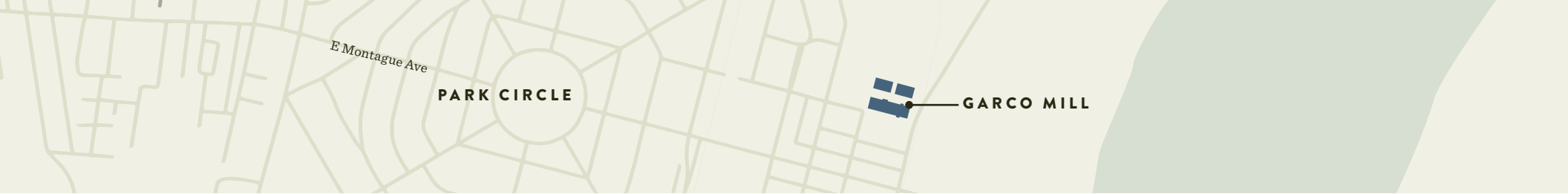

# Navy Yard Charleston Campus

**72 ACRES, 4.2 MILLION SF**

**OF OFFICE, RETAIL, SHOWROOMS, RESIDENTIAL & RESTAURANTS**

Navy Yard Charleston 

Complete Buildings & Neighbors 

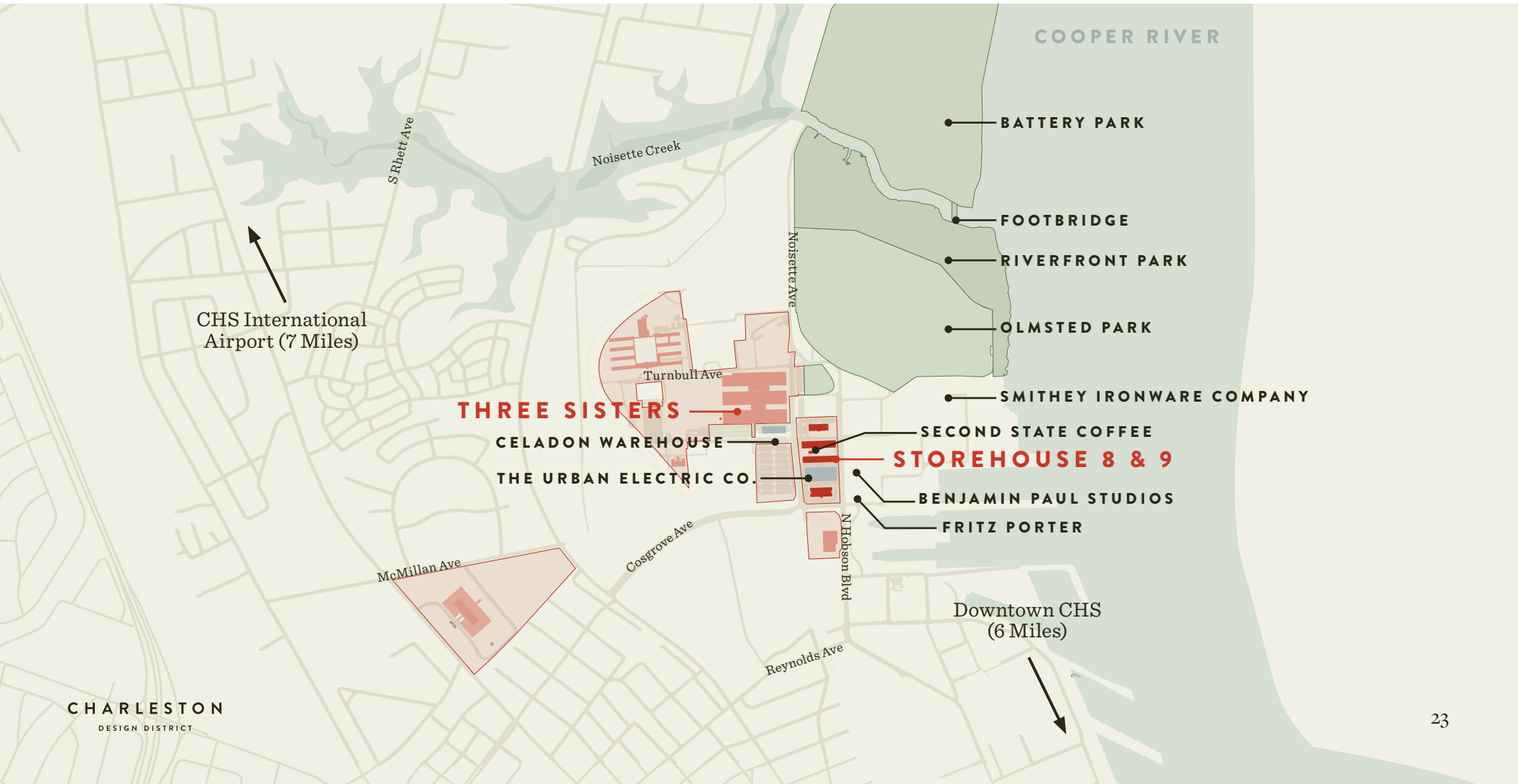

CHS International Airport (7 Miles)

**THREE SISTERS**

CELADON WAREHOUSE

THE URBAN ELECTRIC CO.

**STOREHOUSE 8 & 9**

BENJAMIN PAUL STUDIOS

FRITZ PORTER

COOPER RIVER

BATTERY PARK

FOOTBRIDGE

RIVERFRONT PARK

OLMSTED PARK

SMITHEY IRONWARE COMPANY

SECOND STATE COFFEE

Downtown CHS (6 Miles)

# Area Population

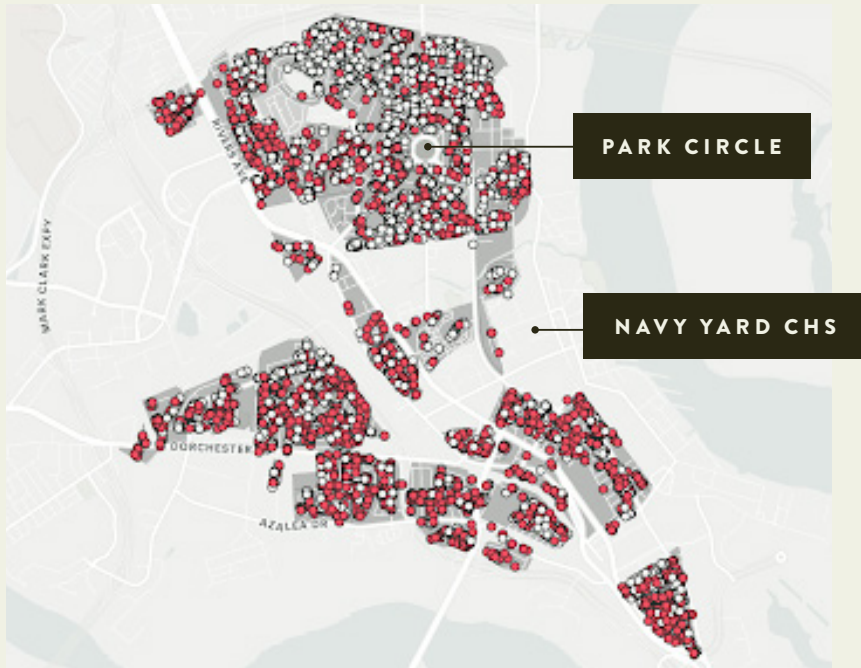

North Charleston residential home neighborhood density from Interstate 526 to the Charleston city line, including the Park Circle area and the south end.

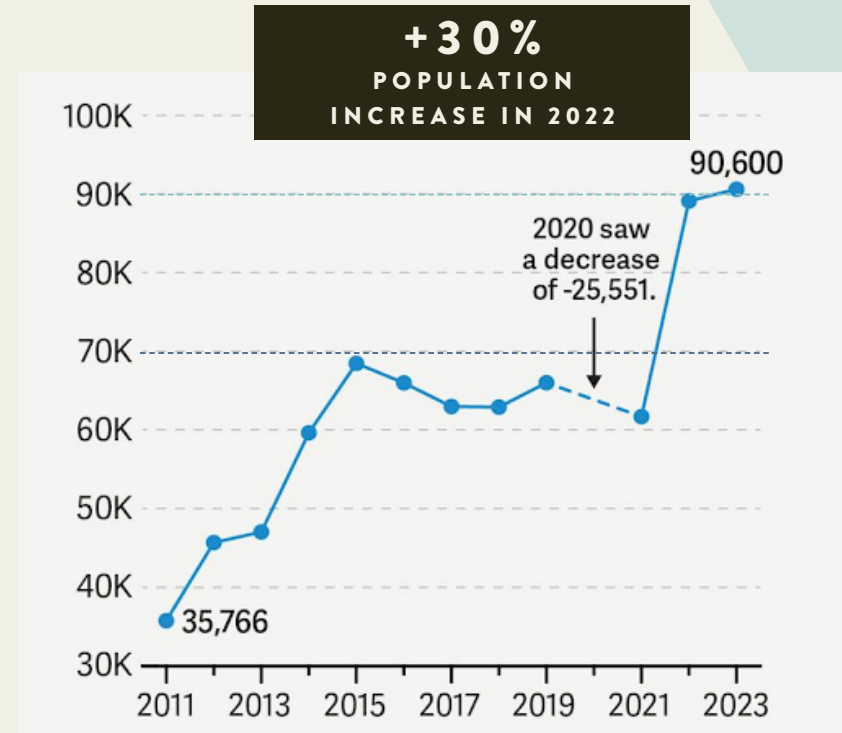

South Carolina's 2022 annual population jumped by more than 30% after declining from its pre-pandemic peak in 2015 and continued its climb into 2023.

# Abundant Parking for Seamless Convenience

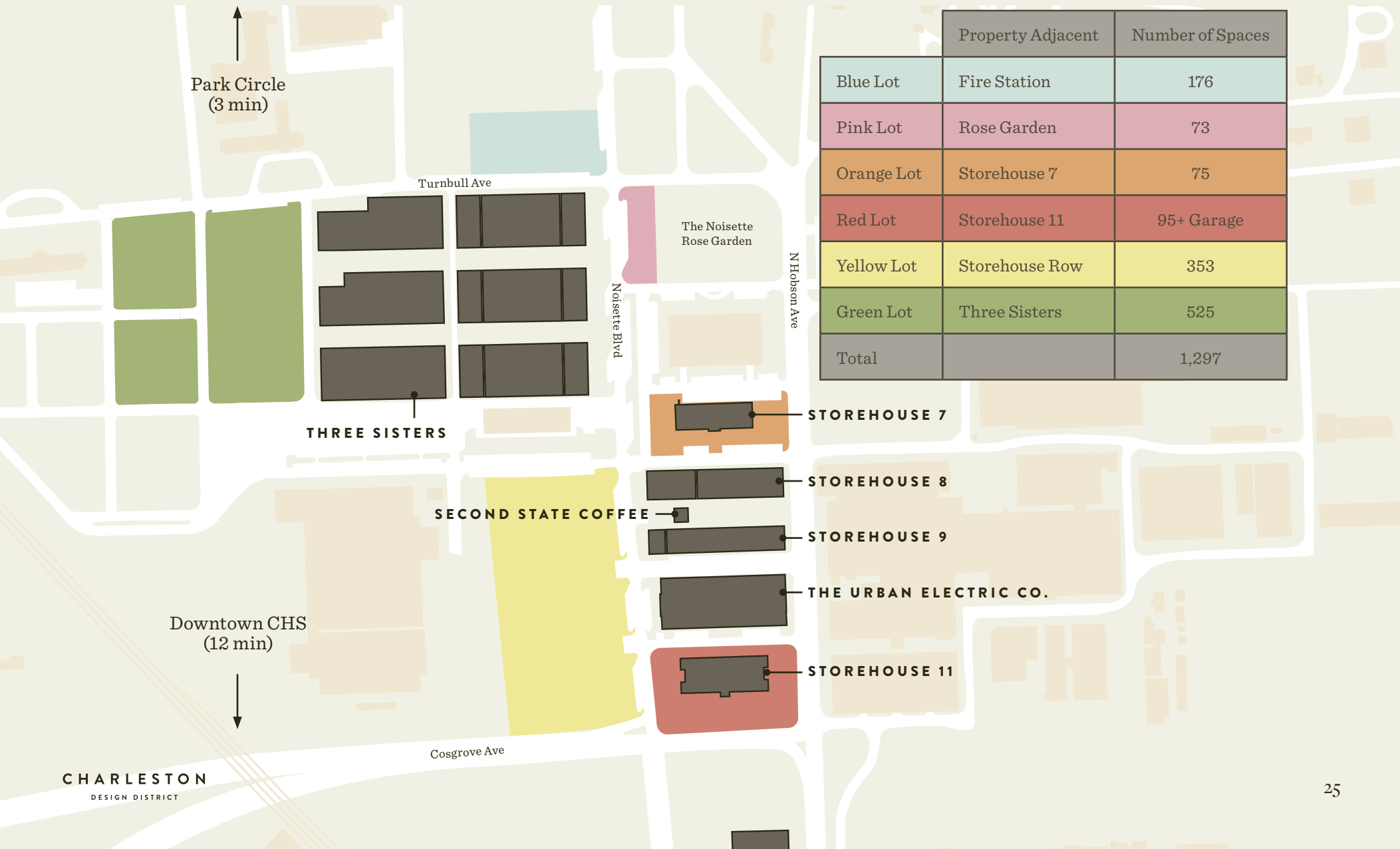



The Cigar Factory  
Charleston, SC



Ponce City Market  
Atlanta, GA



Levi's Plaza  
San Francisco, CA



Navy Yard Charleston  
North Charleston, SC

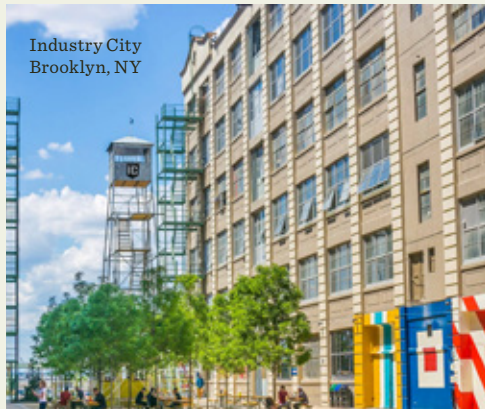

Industry City  
Brooklyn, NY



GARCo Mill  
North Charleston, SC

# Development Team

Jamestown, L.P., WECCO, and Weaver Capital Partners have partnered on Navy Yard Charleston development to create a place that inspires the community.

We have significant experience in developing enduring, dynamic mixed-use, pedestrian oriented urban centers. Our team possesses the imagination, resources, and relationships needed to successfully finance, lease, and operate this historic redevelopment vision. With a local North Charleston office, deeply rooted in community and backed by Jamestown's talent, vertical integration, and global perspective, we have the keen insight and large-scale commitment paired with the local experience of WECCO Development and Weaver Capital to develop this complex, historic neighborhood.

# Our Transformative Mix-Use Developments

DEMONSTRATED HISTORIC ADAPTIVE REUSE AND DESIGN FOCUSED DISTRICTS



**BOSTON DESIGN CENTER**  
Boston, MA



**THE CIGAR FACTORY**  
Charleston, SC

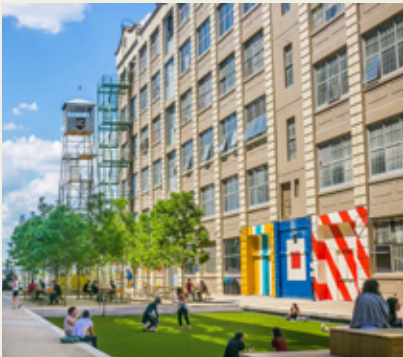

**INDUSTRY CITY**  
New York, NY



**GARCO MILL**  
North Charleston, SC



# Making Place

We believe in the importance of creating places for people to gather, socialize and be inspired. Navy Yard Charleston is committed to offering its community an experience beyond customary retail, showroom and office space, starting with grass roots activations in raw spaces and growing into renovated buildings.

## COMMUNITY PARTNERSHIPS:

Charleston Wine & Food, Charleston Black Expo, Charleston APPI Collective, Charleston Promise Neighborhood, Historic Charleston Foundation, Lowcountry Local First, Lowcountry Orphan Relief

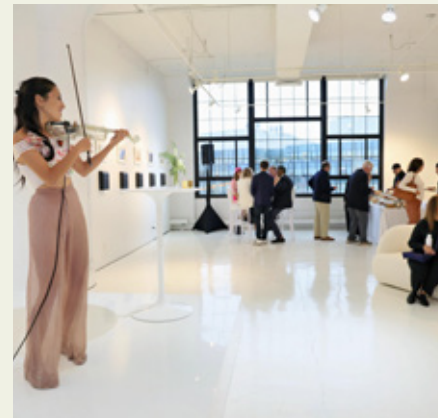



**DESIGN DISTRICT RETAIL & SHOWROOM LEASING**

646.783.1844

[leasing@navyyardchs.com](mailto:leasing@navyyardchs.com)

