

JAMESTOWN PRESENTS

CONCOURSE RESTAURANT SPACE

AT

CHELSEA MARKET

CLAIRE BERNARD — CLAIRE.BERNARD@JAMESTOWNLP.COM
AUSTIN GLOVER — AUSTIN.GLOVER@JAMESTOWNLP.COM



GROUND FLOOR

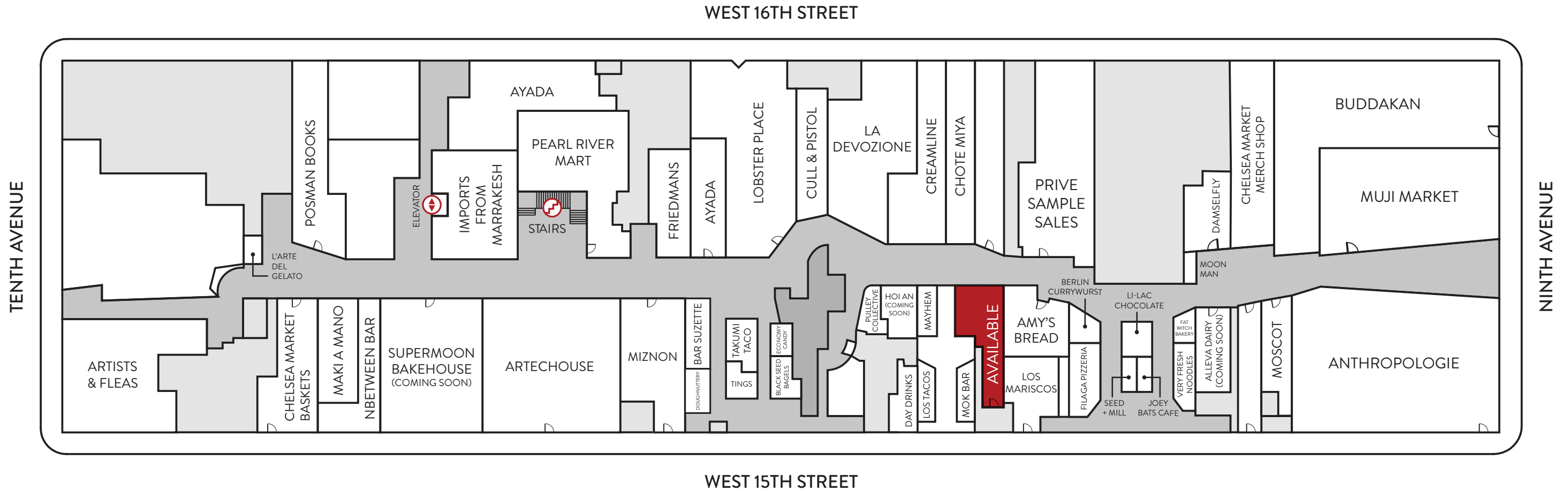

CHELSEA MARKET DETAILS

KEY NEIGHBORHOOD TENANTS



- Avg dwell time 70 minutes
- 6M annual visitors
- Unique co-tenancy with classic New York brands like Moscot, Economy Candy, Li-Lac Chocolates mixed with incredible one of a kind food operators, Los Tacos, Very Fresh Noodles, Lobster Place and Ayada Thai

GROUND FLOOR SPACE PLAN

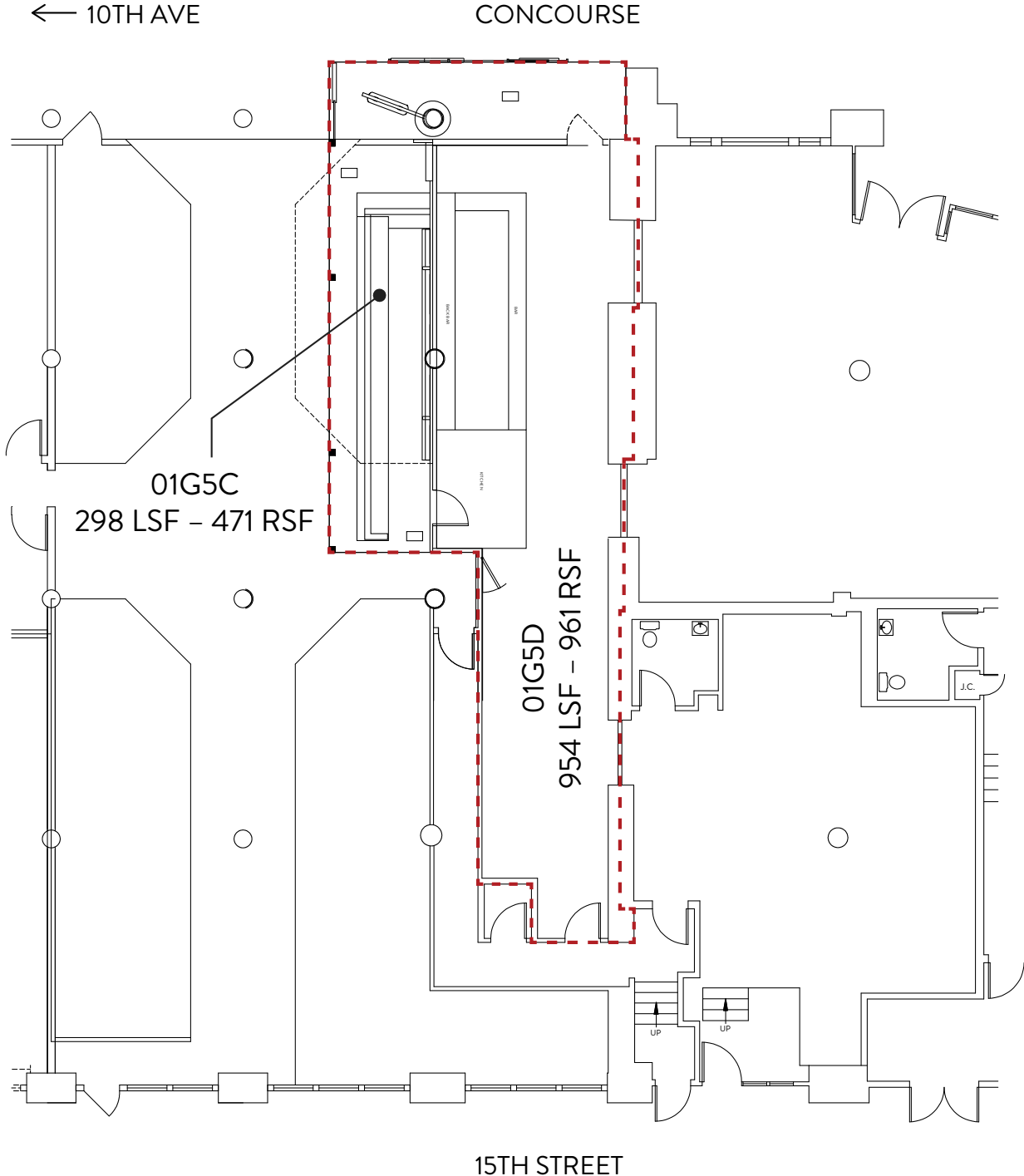

SPACE DETAILS

LOCATION

- Ground Floor; Close to 9th Ave Entrance

SPACE SIZE

- 1,432 SF

POSSESSION

- Immediate

TERM

- Long Term

FRONTAGE

- 13'

SITE STATUS

- Second Generation Wine Bar
- Self Contained Exhaust





NEIGHBORHOOD

- Adjacent to Highline (7.6M visitors); Chelsea Piers (4M visitors)
- The nexus of Chelsea and Meatpacking
- Dynamic 24/7 neighborhood surrounded by Google's New York Campus, high-density residential, night life and recreation
- 4.2M SF of office space within a one mile radius
- 1,800 hotel rooms in the neighborhood
- Pier 57, Hudson River Park Beach and Little Island

JAMESTOWN PRESENTS

CHELSEA LOCAL RESTAURANT SPACE

AT

CHELSEA MARKET

CLAIRE BERNARD — CLAIRE.BERNARD@JAMESTOWNLP.COM

AUSTIN GLOVER — AUSTIN.GLOVER@JAMESTOWNLP.COM



GROUND FLOOR

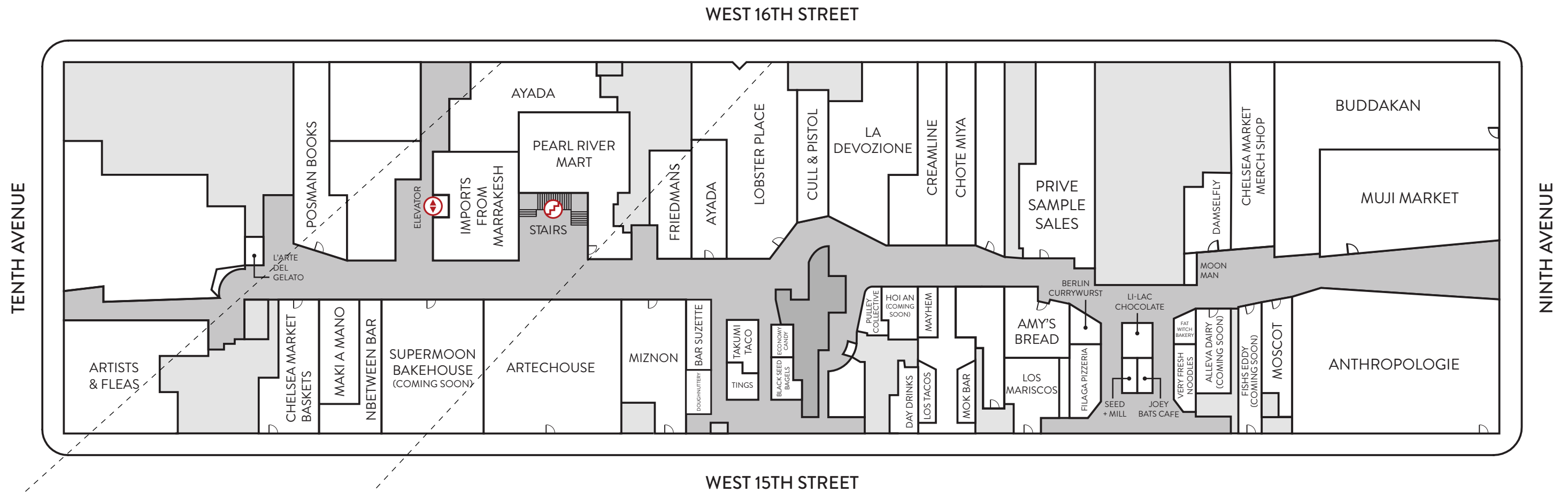

CHELSEA MARKET DETAILS

KEY NEIGHBORHOOD TENANTS



- Avg dwell time 70 minutes
- 6M annual visitors
- Unique co-tenancy with classic New York brands like Moscot, Economy Candy, Li-Lac Chocolates mixed with incredible one of a kind food operators, Los Tacos, Very Fresh Noodles, Lobster Place and Ayada Thai

SPACE PLAN

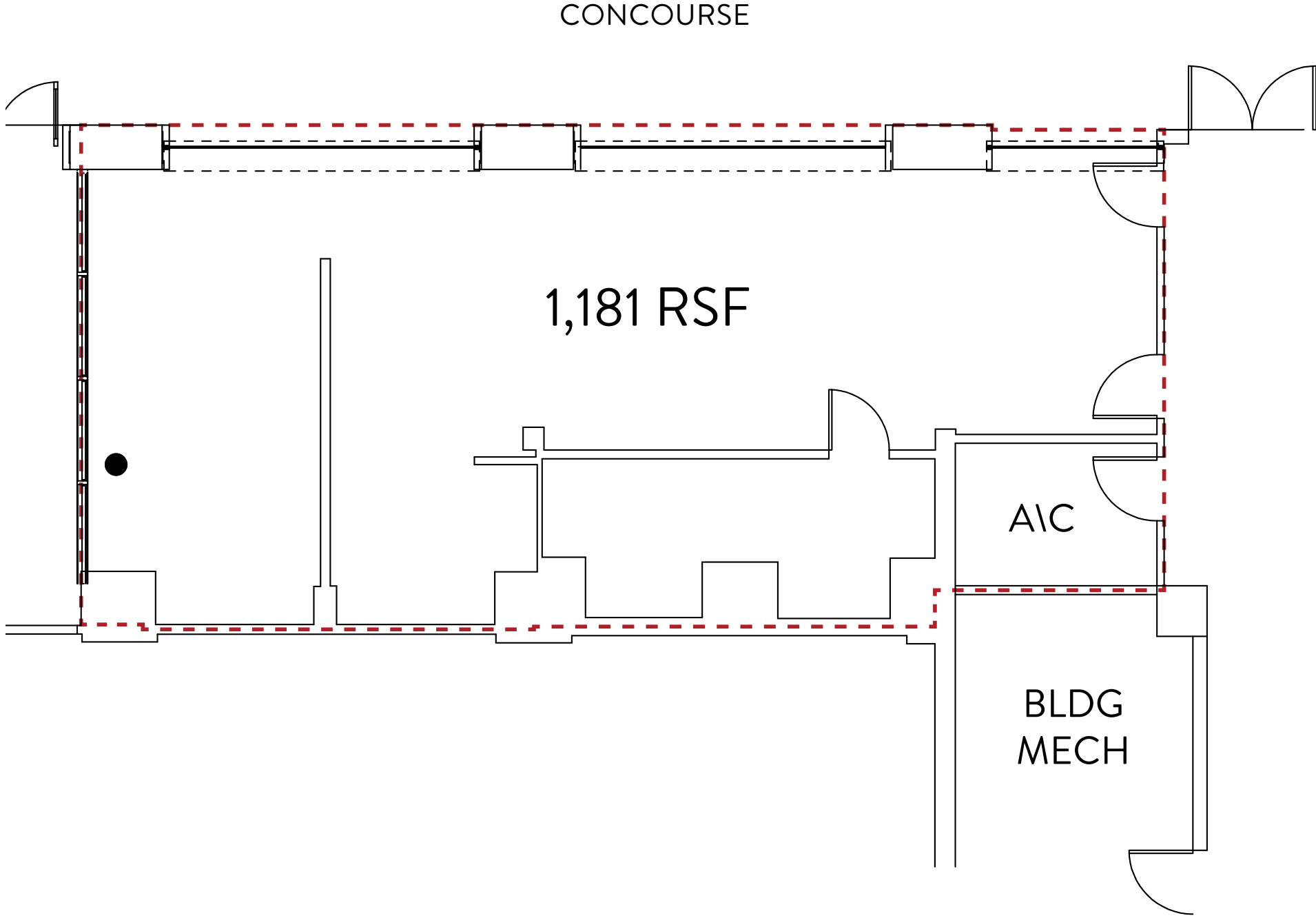

SPACE DETAILS

LOCATION

- Opens to Chelsea Local, Lower Level

SPACE SIZE

- 1,181

POSSESSION

- Immediate

TERM

- Long Term

FRONTAGE

- Approximately xx'

SITE STATUS

- 2nd Generation Bakery with heat exhaust





NEIGHBORHOOD

- Adjacent to Highline (7.6M visitors); Chelsea Piers (4M visitors)
- The nexus of Chelsea and Meatpacking
- Dynamic 24/7 neighborhood surrounded by Google's New York Campus, high-density residential, night life and recreation
- 4.2M SF of office space within a one mile radius
- 1,800 hotel rooms in the neighborhood
- Pier 57, Hudson River Park Beach and Little Island